

Flow cell for the Swansensor Oxysafe1000.

Flow cell M-Flow M40

Flow cell made of PVC and acrylic glass with one M40 x 1.5 sensor opening. Suitable for Ø 32 mm sensors with M40 adapter.

Removable transparent vessel allows easy sensor calibration and maintenance.

Technical data

Sample connections

- Inlet and outlet: G ¼" thread
Equipped with hose nozzle for 10mm tube.

Sample conditions

(for the flow cell without sensor!)

- Flow rate: 4 to 15 l/h
- Temperature: up to 50 °C
- Inlet pressure @ 25 °C: up to 1 bar
- Pressure-free outlet (atmospheric drain)
- No strong acids and bases
- No organic solvents

Dimensions

- Width: 90 ... 142 mm
- Front-to-back: 105 mm
- Height: 161 mm
- Panel mounting: 3 screws M5

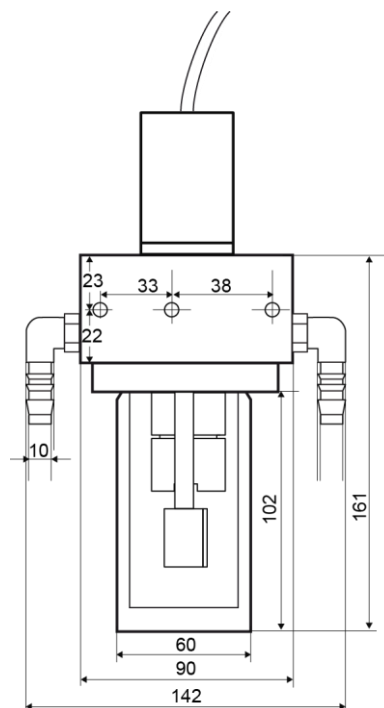

M-Flow M40 with Swansensor Oxysafe1000 (not included).

Delivery includes:

Flow cell M-Flow M40 with sensor incident flow tube, and two 90° elbow hose nozzle ¼" for 10mm tube at sample in- and outlet. Set of mounting screws. Sensor mounting adapter for Ø 32 mm sensor in M40 thread (A-83.910.060)

Order Nr.	M-Flow M40	A-83.422.330
Accessory	[] Mounting panel for flow cell made of white PVC. Dimensions (w x h x d): 280 x 200 x 10 mm	A-89.410.110
	[] Swansensor deltaT Flow	A-87.933.010